

Revision Notes:

Drawn:- Checked:- Approved:- Date:-

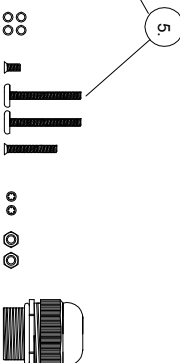
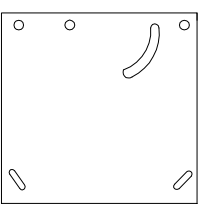
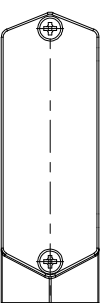
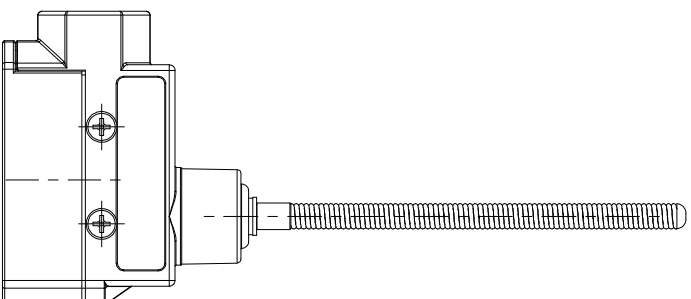
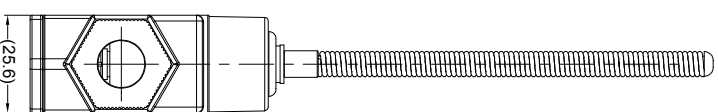
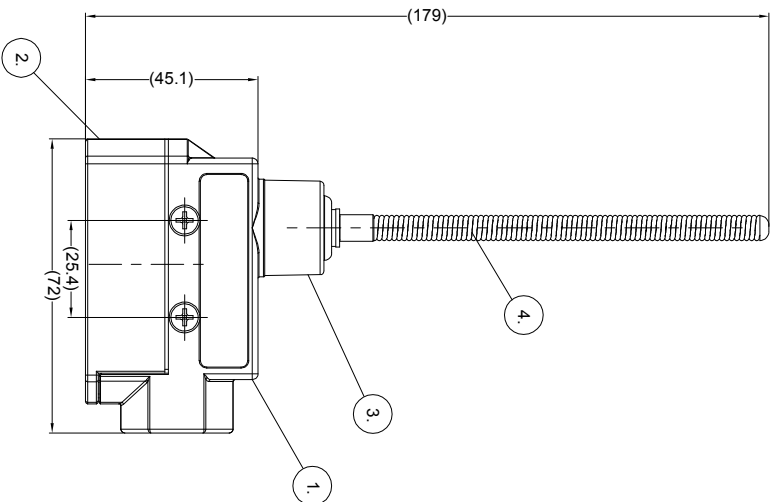

SPECIFICATION:

1. MICRO-SWITCH: SINGLE POLE-DOUBLE THROW
2. WORKING VOLTAGE RANGE: 12 TO 80 VOLTS
3. RATED CONTACT LOAD:
  - MAXIMUM 10 AMPERES AT 12 VOLTS
  - MAXIMUM 8 AMPERES AT 24 VOLTS
  - MAXIMUM 2 AMPERES AT 48 VOLTS
  - MAXIMUM 1 AMPERE AT 80 VOLTS
4. MECHANICAL DURABILITY: TO BE FREE OF ABNORMALITY OPERATED FOR 100 THOUSAND TIMES WITH SWITCHING FREQUENCY OF 20 CYCLES PER MINUTE FOR RIGHT-LEFT AND FORWARD-BACKWARD.
5. ELECTRICAL DURABILITY: TO BE FREE OF ABNORMALITY OPERATED FOR 100 THOUSAND TIMES WITH SWITCHING FREQUENCY OF 20 CYCLES PER MINUTE WITH RATED LOAD.
6. INSULATING RESISTANCE: 100MΩ OR ABOVE (AS MEASURED BY DC500V INSULATING METER).
7. EXTREME VOLTAGE TEST: TO BE FREE OF ABNORMALITY AFTER BEING SUBJECTED TO AC2000 VOLTS FOR ONE MINUTE BETWEEN ANY TERMINALS AND CASE.
8. CONTACT IMPEDANCE(INITIAL): LESS THAN 50mΩ.
9. VIBRATION: VIBRATE TEST AT 10G IN ACCORDANCE WITH SAE (WORKING SITUATION SUBJECT TO SAE).
10. IMPACT STRENGTH: 300m/s<sup>2</sup> OR ABOVE WITH ACTUATOR.
11. WATERPROOF: TO BE FREE OF ABNORMALITY AFTER HIGH PRESSURE WATER TEST PER SAE J994.
12. CORROSION TEST: TO BE FREE OF ABNORMALITY AFTER SALT SPRAY TEST PER ASTM B117 FOR 50 HOURS.
13. MAXIMAL SWITCHING FREQUENCY: 20 CYCLES PER MINUTE.
14. WORKING TEMPERATURE RANGE: -25°C TO +80°C (WITHOUT FREEZING AND DEW).
15. ENDURANCE TEST AT LOW TEMPERATURE: FOUR HOURS AT -25°C AT THE EXTREME LOW SYSTEM VOLTAGE.
16. ENDURANCE TEST AT HIGH TEMPERATURE: FOUR HOURS AT 85°C AT THE EXTREME HIGH SYSTEM VOLTAGE.
17. SWITCH OPERATING CHARACTERISTICS:
  - OPERATING STRENGTH: 4.5N FOR RANDOM ORIENTATION
  - OPERATING ANGLE: 15 ± 5 DEGREES FOR RANDOM ORIENTATION
  - STROKE: 0.8mm

PARTS LIST:

PART NO.:	QUANTITY
CONNECTOR ASSEMBLY	1
M4 SCREW *25	2
M3 SCREW *6	1
M3 SCREW *25	1
NUT FOR M4	2
O RING	4
BRACKET	1
TOOTHED LOCK WASHER	2

CONNECTOR ASSEMBLY CONTENTS

PART NAME:	PART NUMBER:	QUANTITY:	MATERIAL:
1 CABINET UPPER	TS87/0160003	1	ZINC ALLOY
2 CABINET LOWER	TS87/0160004	1	ZINC ALLOY
3 WATERPROOF COVER	TS87/0160005	1	CR
4 SPRING POLE	TS87/0160016	1	SUS304
5 MISC FIXINGS		1	

Assembly Pl Approval  
K.IIDA - 5/2/13

Angle of Projection

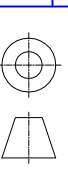

Third Angle

Approved by  
S.MATTHEWS

Checked by  
GPLTH

Released  
06/2/13

Scale  
N/A

Units  
mm

Status  
Released

Part No  
0153

Drawn by  
RBATES

Assembly Ref  
-

**BRIGADE**

www.brigade-electronics.com

SW-16

BE-002253-00-12

PROPRIETARY NOTICE  
THIS DESIGN AND TECHNICAL INFORMATION APPEARING ON THIS DRAWING IS THE PROPERTY OF BRIGADE ELECTRONICS, AND IS DISCLOSED IN CONFIDENCE. IT IS NOT TO BE COPIED, REPRODUCED, REVEALED TO OR EXPLOITED BY OTHERS, EITHER IN WHOLE OR IN PART WITHOUT THE EXPRESS WRITTEN CONSENT OF BRIGADE ELECTRONICS.